

(55 SERIES) TD2

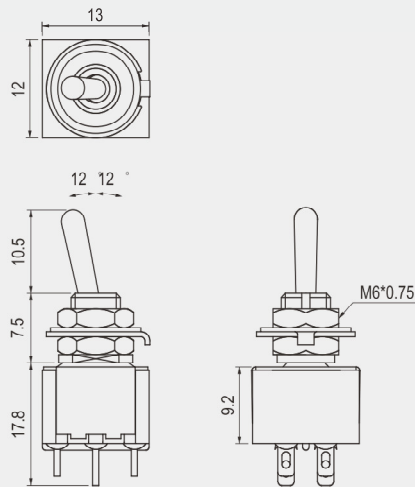

Rating

10A 125V AC
6A 250V AC

Contact resistant

50mΩ Max

Insulation resistant

DC 500V 100MΩ Min

Dielectric strength

AC 1000V 1 minute

Cut out

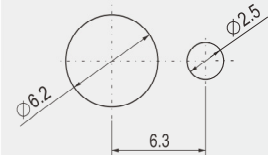

± 1 mm max

FEATURES

- * MATERIAL: Phenolic base (UL flame: 94V-0).
- * Contacts and Terminals are copper with silver alloy and silver plated.
- * Epoxy sealed for dust and moisture resistant.
- * Colorful handle covers and watertight boot are optional for toggle type A.



TD2

FUNCTION

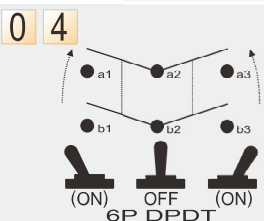
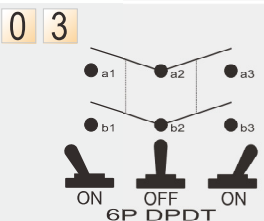
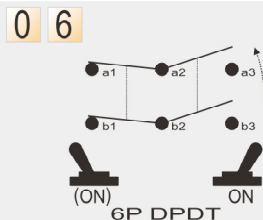
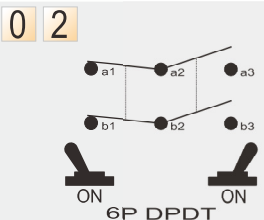
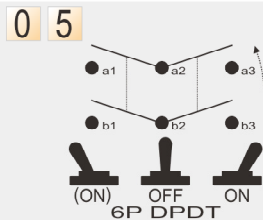
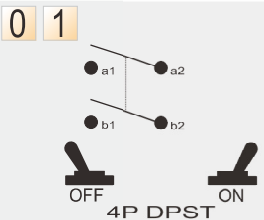

LEVER

A Standard



F Flat

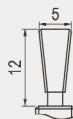

G Plastic

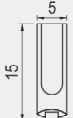

TERMINAL

1 SO

2 PC

3 PC Angle(2.54)

5 PC Angle(3.8)

